

# EasyPrint WAS

## Web Advance System

The Web Advance System attaches directly to the EasyPrint MLP

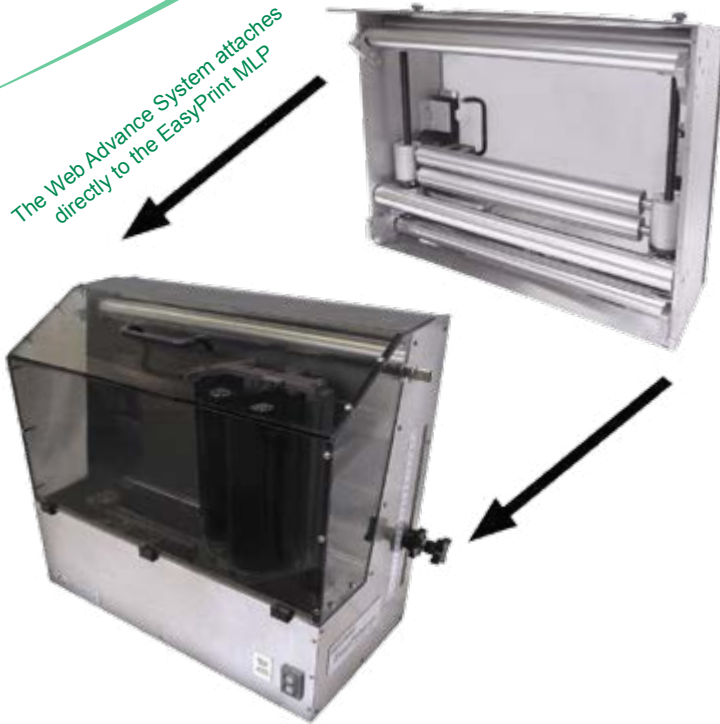

Attaches directly to an EasyPrint mlp, and allows for multiple rows of printing on Horizontal Form/Fill/ Seal machines, without the need for additional print stations.

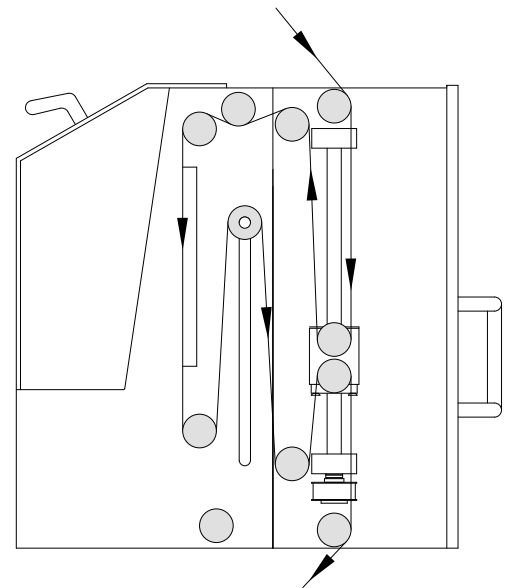

### Incorporates:

Index Roll with a 14" Max. Web Movement

### Dimensions:

440 Printer = 2", 5" Print Head = 16.12" Height  
8.3" Print Head = 20.8" Height  
26.68" Width  
7" Depth

630 Printer = 2", 5" Print Head = 16.12" Height  
8.3" Print Head = 20.8" Height  
34.49" Width  
7" Depth

